

POLLICI



1"

ESAGONO

MISURE IN POLLICI - A RICHIESTA ALTRE MISURE

attacco: 1"

impronta: ESAGONO

FEFMEC articolo	pollici	L mm	
1991-7/8	7/8"	55	1
1991-15/16	15/16"	55	1
1991-1	1"	55	1
1991-1-1/8	1-1/8"	57	1
1991-1-1/4	1-1/4"	57	1
1991-1-5/16	1-5/16"	60	1
1991-1-7/16	1-7/16"	60	1
1991-1-9/16	1-9/16"	64	1
1991-1-5/8	1-5/8"	69	1
1991-1-11/16	1-11/16"	69	1
1991-1-3/4	1-3/4"	69	1
1991-1-7/8	1-7/8"	72	1
1991-1-15/16	1-15/16"	72	1
1991-2	2"	72	1
1991-2-1/16	2-1/16"	80	1
1991-2-3/16	2-3/16"	80	1
1991-2-1/4	2-1/4"	80	1
1991-2-5/16	2-5/16"	85	1
1991-2-3/8	2-3/8"	85	1
1991-2-7/16	2-7/16"	85	1
1991-2-1/2	2-1/2"	85	1
1991-2-5/8	2-5/8"	91	1
1991-2-11/16	2-11/16"	91	1
1991-2-13/16	2-13/16"	92	1
1991-2-7/8	2-7/8"	92	1
1991-3	3"	97	1
1991-3-1/16	3-1/16"	100	1
1991-3-1/8	3-1/8"	100	1
1991-3-3/16	3-3/16"	100	1
1991-3-1/4	3-1/4"	100	1
1991-3-5/16	3-5/16"	100	1
1991-3-3/8	3-3/8"	104	1
1991-3-7/16	3-7/16"	104	1
1991-3-1/2	3-1/2"	104	1
1991-3-9/16	3-9/16"	104	1
1991-3-5/8	3-5/8"	104	1
1991-3-11/16	3-11/16"	104	1
1991-3-13/16	3-13/16"	112	1
1991-3-7/8	3-7/8"	112	1
1991-4	4"	112	1

1"

POLIGONALE

POLIGONALI

attacco: 1"

impronta: POLIGONALE

FEFMEC articolo	mm	L mm	
1991-19 DSKT	19	55	1
1991-20 DSKT	20	55	1
1991-21 DSKT	21	55	1
1991-22 DSKT	22	55	1
1991-24 DSKT	24	55	1
1991-25 DSKT	25	55	1
1991-26 DSKT	26	55	1
1991-27 DSKT	27	55	1
1991-30 DSKT	30	57	1
1991-32 DSKT	32	57	1
1991-33 DSKT	33	57	1
1991-35 DSKT	35	60	1
1991-36 DSKT	36	60	1
1991-38 DSKT	38	64	1
1991-40 DSKT	40	64	1
1991-41 DSKT	41	64	1
1991-46 DSKT	46	64	1
1991-47 DSKT	47	64	1
1991-50 DSKT	50	67	1
1991-54 DSKT	54	71	1
1991-55 DSKT	55	71	1
1991-58 DSKT	58	75	1
1991-60 DSKT	60	80	1
1991-65 DSKT	65	85	1
1991-70 DSKT	70	88	1
1991-75 DSKT	75	100	1
1991-80 DSKT	80	100	1
1991-85 DSKT	85	100	1
1991-90 DSKT	90	104	1
1991-95 DSKT	95	106	1
1991-100 DSKT	100	112	1
1991-105 DSKT	105	112	1
1991-110 DSKT	110	122	1
1991-115 DSKT	115	122	1



POLIGONALE

CHIAVI A BUSSOLA
A MACCHINA
BOCCA POLIGONALE

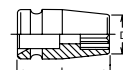

Kokon articolo	mm	D mm	L mm	
18405M-24	24	41.5	57	1
18405M-27	27	45.3	57	1
18405M-30	30	49	62	1
18405M-32	32	51.5	62	1
18405M-33	33	52.8	62	1
18405M-35	35	55.3	62	1
18405M-36	36	56.5	62	1
18405M-38	38	59	66	1
18405M-40	40	62.8	66	1
18405M-41	41	61.5	66	1
18405M-46	46	69	70	1
18405M-50	50	74	70	1
18405M-55	55	80.3	75	1
18405M-56	56	81.5	75	1
18405M-60	60	86.5	75	1
18405M-65	65	92.8	75	1
18405M-70	70	99	75	1
18405M-75	75	105.3	80	1
18405M-80	80	111.5	85	1



POLIGONALE

CHIAVI A BUSSOLA
A MACCHINA
BOCCA POLIGONALE
RIBASSATE

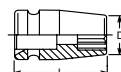

Kokon articolo	mm	D mm	L mm	
18405M-50(D68)	50	68	75	1
18405M-55(D76)	55	76	75	1
18405M-65(D87)	65	87	75	1

IMPACT 1"